

**Unit 23802 Orchid Residences
Orchid Tower
6 Orchid Avenue
Surfers Paradise**

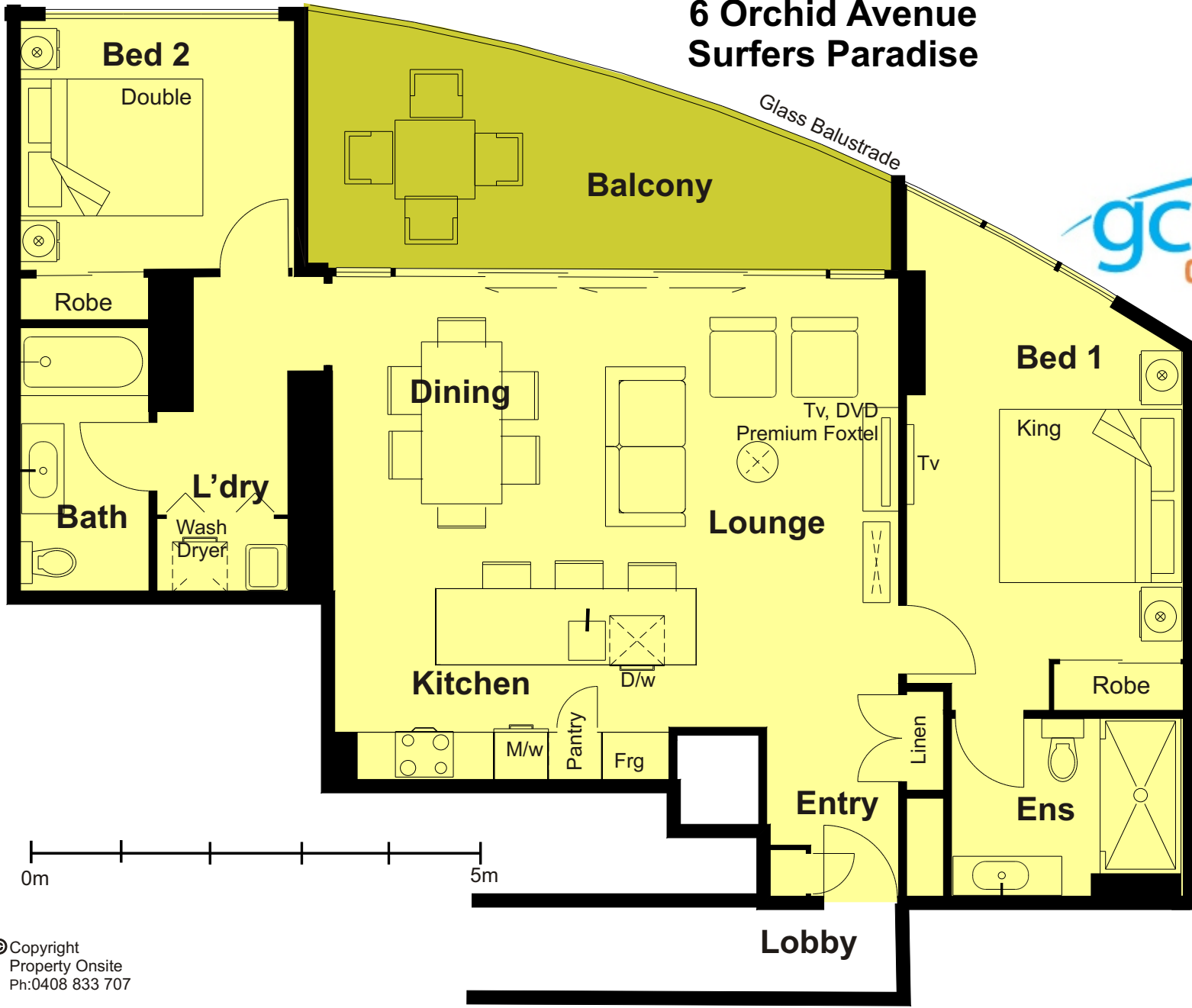

Area Living 84 sq m
Area Balcony 14 sq m



- Inclusions :**
- Free Wi Fi
 - Premium Foptel
 - CD / DVD
 - Ducted Air-Cond
 - Free Car Park

Note
While every endeavor has been made to verify the correct detail in this brochure, neither the Agent or contracted illustrator accept liability for any error or omission.